

Cycle Event - Glasshouse Mountains

Hold Intersection *

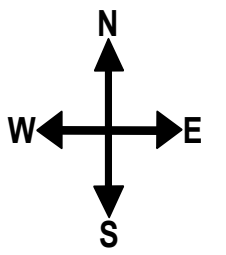

Legend

- Cyclist Route
- QLD Police
- S/Term: 200mm (H)

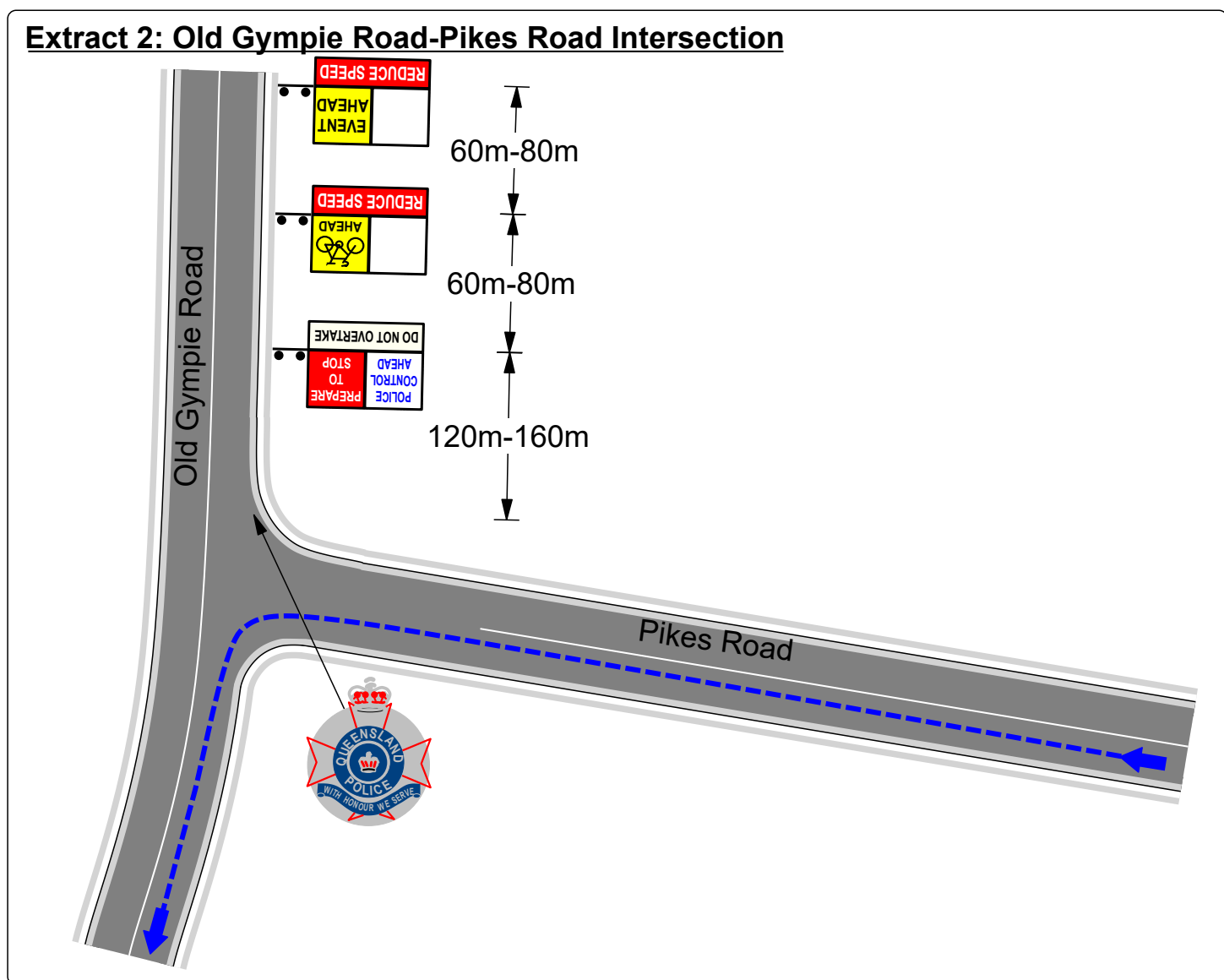
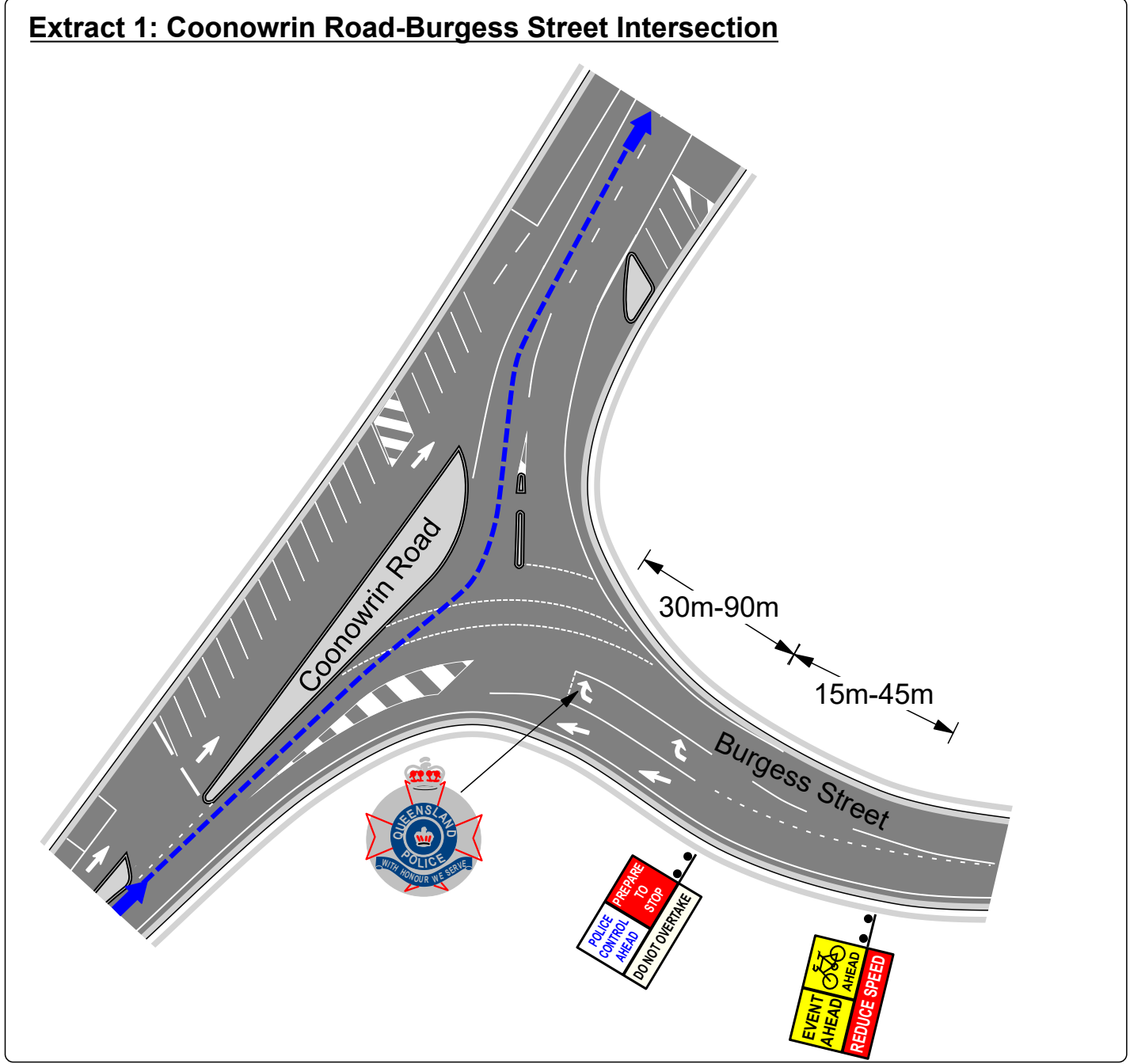

traffic management people
traffic planning and training

AS 4801 ISO 9001
O H & S QUALITY

| | |
|-------------------------|--|
| TMR Register No. | 0080 |
| Job Location: | Cyclist Event - Glasshouse Mountains |
| Client: | Australasian Police & Emergency Services Games |
| Drawn By: | Douglas Pettigrew |
| TMD Open Certification: | OP 239 |
| Date: | 04/08/2016 |
| Signed: | |
| Job No.: | J003500-3 |
| Scale: | NTS |
| Sheet No.: | 1 of 1 |
| Version No.: | 1 |

Disclaimer: This plan has been prepared as a guide for Traffic Management Purposes from information supplied by third parties. Traffic Management People at all times attempt to be as accurate as possible but disclaims all responsibility and all liability (including without limitation, liability in negligence) for all expenses, losses, damages and costs you might incur as a result of the information being inaccurate or incomplete in any way, and for any reason.

A site specific risk assessment conducted by a competent person is required before implementing this plan.

1. Police Control will hold all traffic turning into cyclist path. Vehicles to be release in break in Pelaton.